

# CAD Management Session I



2-A | 9:00 - 10:15 am

Instructor: Javier Chavez

## Introduction

This course focuses best practices for setting up and deploying Autodesk software throughout your organization as well as some tips on how to migrate to the next release. Implementing any type of software can be a daunting task especially if you are not necessarily familiar with all the different nuances of the software. While a novel can easily be written on all the specifics of a good implementation of Autodesk software, this course will focus on identifying some of the most relevant steps necessary for a successful implementation. More detailed documents and exercises will be made available online, however this document will outline the basic steps as they pertain to Inventor and AutoCAD based products. The subjects discussed in this course are not only based on my own personal experience, but the experience of our staff, and even our customers.

## Centralizing Resources

Standardization greatly affects the quality of our work and is a key factor in the efficiency, and productivity of the best in class organizations. One of the first things that come to mind when I think of this subject is the centralizing support files and data. When files such as templates, printer support files, libraries, are centralized by moving them and pointing users to a network location of these files, it reduces errors by maintaining the consistency our engineering documents. It basically assures that all users are on the same page. When a change is made to the any of the centralized data, you can be assured that you've updated all users in one step as opposed to repeating the process on multiple stations. This will be accomplished by customization. So the question is, what can we standardize and how do we customize our installation so that we centralize this information? To help answer this question we have identified some of these key components.

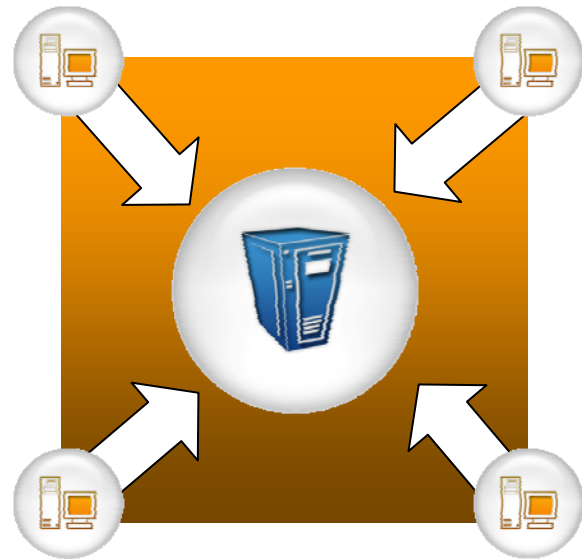

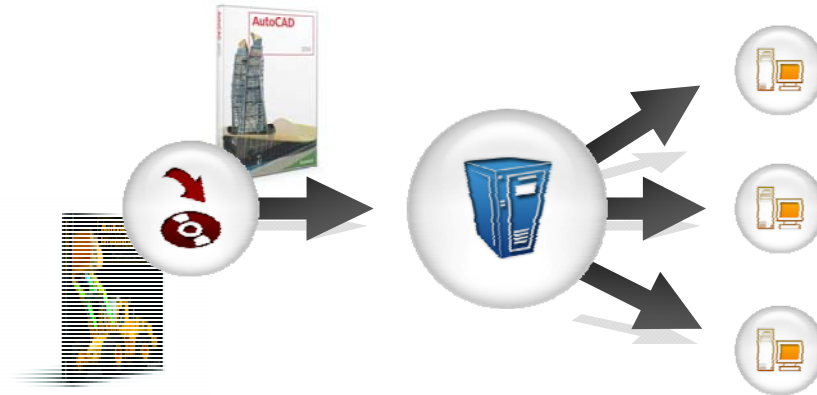

## Software Deployment

Most users have had the pleasure of installing software, entering registration information and answering the plethora of questions asked in the installation dialog. However, most users have not explored the deployment tools and installation options available during installation. These hidden tools are a CAD Manager's best friend, and will aid in making sure those installations;

- Adhere to company standards
- Include customizations
- Are consistent from station to station

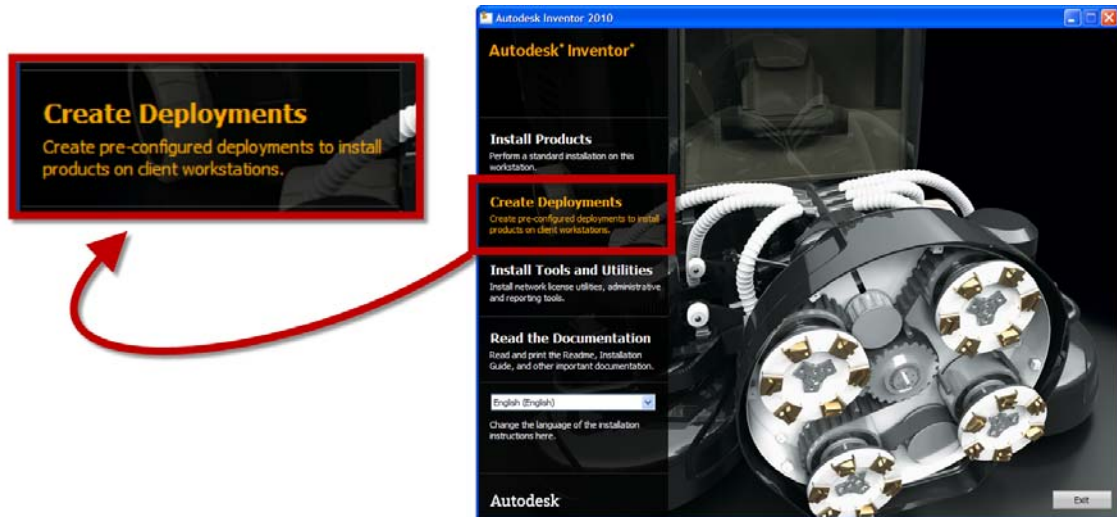

## The Deployment Wizard

This tool is included with almost every Autodesk software title. Although this tool was originally intended for network licenses, the latest releases allow it to be used with multi-seat standalone licenses. It allows users to create a pre-configured installation (deployment) of your software on a shared network location. From there one can simply install the software from shortcut located in the shared network location. When installing from this shortcut, users do not need to enter any registration information or answer any questions. Those have all been pre-configured in the creation of the deployment.

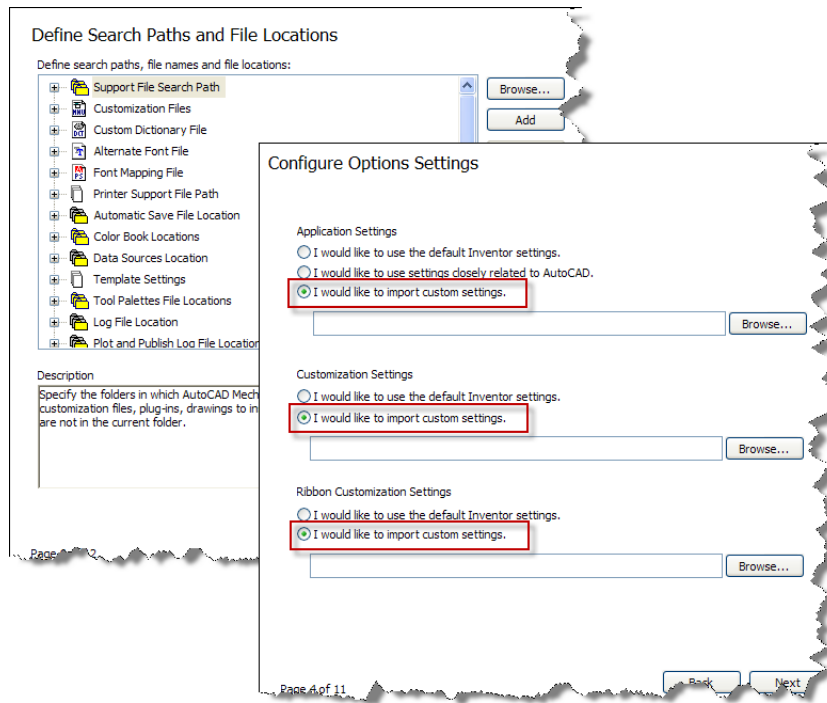

### Customizing Your Deployments

During the creation of your deployment you have the option of including the customizations that we identified earlier (the ones that centralize your resources). This step is often overlooked during the creation of a deployment and might be the most critical. Not including your customizations in your deployment, will mostly likely mean that you will end up applying these customizations one station at time. In doing so, you also risk applying these customizations inconsistently. The steps are slightly different between AutoCAD and Inventor based products, however details on both are included in the documentation.

### Migration

When a new release is available we usually think of new features. This is the exciting part. However migrating files and settings can be source of frustration for many. AutoCAD based products in particular, contain a dizzying array support files. The good news is that if you centralized some your resources, this task will help simplify this task. Of course the list doesn't end there. Below are just a few examples of files and settings that might need to be migrated. Again, more detailed documents and exercises will be made available online.

#### AutoCAD

- Profiles
- Workspaces/CUI Files
- DWG files/templates

#### Inventor

- All drawing, part, and assembly files
- Content Center Files
- Library Files